

HW-TSP004

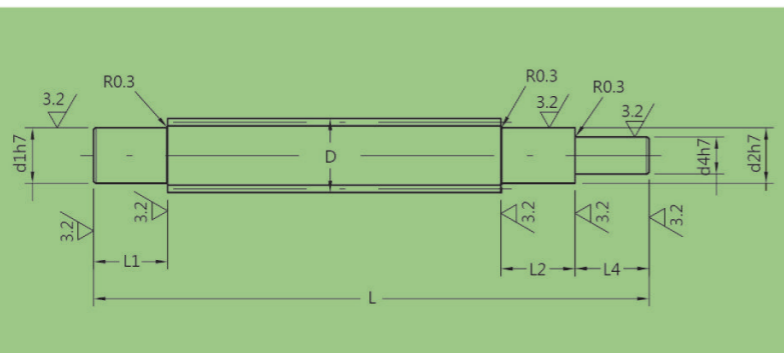

Type 項次	Material 材質	Surface Treatment 表面處理	Delivery 交貨日
HW-TSP004-A	S45C 中碳鋼	-	10 Working Days
HW-TSP004-B		Blackening 染黑	10 個工作日

Type	D	L (u:1mm)	L1/L2/L4 (u:1mm)	d1/d2	d4 (u:1mm)	Pitch
HW-TSP004-A HW-TSP004-B	12	80~1000	2≤L1≤d4 or d1x7 2≤L4≤d4 or d1x7 2≤L2≤d2x7	7/8/9	d2/2≤d4≤d2-1	2
	14	80~1000		8/9/10		3
	16	100~1200		9/10/12		3
	18	150~1200		9/10/12		4
	20	150~1200		10/12/14/15		4
	22	150~1200	10/12/14/15	5		
	25	150~1200	※When d1, d2 and d4≤9	12/14/15/16/17		5
	28	150~1200	L1≤d1x5 L2≤d2x5 L4≤d4x5	14/15/16/17/20		5
	32	200~1200		14/15/16/17/20/25		6
	36	200~1200		17/20/25		6
40	200~1200		20/25/30	6		
50	200~1200		25/30/35/40	8		

Order Ex. 訂購範例

HW-TSP004-D-L-d1-L1-d2-L2-d4-L4

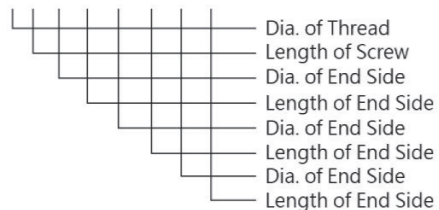

螺紋尺寸
螺桿長度
軸端尺寸
軸端長度
軸端尺寸
軸端長度
軸端尺寸
軸端長度

Alterations 追加名稱	Description 加工說明	Order Ex. 訂購範例																																																												
A 	Flat Machining 平面追加加工。	HW-TSP004-12-80-9-10-9-10-7-10-Ad1 or Ad4-3(L5)-5(L6)-1(L7) Flat Machining at the d1 or d4 Side. 在d1或d4端進行平面追加加工。																																																												
B 	Retaining Ring Groove 扣環溝槽追加加工。 <table border="1"> <thead> <tr> <th>d1(d4)</th> <th>e</th> <th>m</th> <th>n</th> </tr> </thead> <tbody> <tr><td>7</td><td>4</td><td>+0.075</td><td>0.7</td></tr> <tr><td>8</td><td>5</td><td>0</td><td></td></tr> <tr><td>9</td><td>6</td><td>0.9</td><td>n≥1.2</td></tr> <tr><td>10</td><td>9.6</td><td>0</td><td></td></tr> <tr><td>12</td><td>11.5</td><td>-0.09</td><td></td></tr> <tr><td>14</td><td>13.4</td><td>0</td><td>1.15</td></tr> <tr><td>15</td><td>14.3</td><td>-0.11</td><td>+0.14</td></tr> <tr><td>16</td><td>15.2</td><td>0</td><td>n≥1.5</td></tr> <tr><td>17</td><td>16.2</td><td></td><td></td></tr> <tr><td>20</td><td>19</td><td>0</td><td>1.35</td></tr> <tr><td>25</td><td>23.9</td><td>-0.21</td><td>1.65</td></tr> <tr><td>30</td><td>28.6</td><td>0</td><td></td></tr> <tr><td>35</td><td>33</td><td>0</td><td></td></tr> <tr><td>40</td><td>38</td><td>0</td><td>n≥2</td></tr> </tbody> </table>	d1(d4)	e	m	n	7	4	+0.075	0.7	8	5	0		9	6	0.9	n≥1.2	10	9.6	0		12	11.5	-0.09		14	13.4	0	1.15	15	14.3	-0.11	+0.14	16	15.2	0	n≥1.5	17	16.2			20	19	0	1.35	25	23.9	-0.21	1.65	30	28.6	0		35	33	0		40	38	0	n≥2	HW-TSP004-12-80-9-10-9-10-7-10-Bd1 or Bd4-6(L8) Retaining Ring Groove at the d1 or d4 Side. 在d1或d4端進行扣環溝槽追加加工。
d1(d4)	e	m	n																																																											
7	4	+0.075	0.7																																																											
8	5	0																																																												
9	6	0.9	n≥1.2																																																											
10	9.6	0																																																												
12	11.5	-0.09																																																												
14	13.4	0	1.15																																																											
15	14.3	-0.11	+0.14																																																											
16	15.2	0	n≥1.5																																																											
17	16.2																																																													
20	19	0	1.35																																																											
25	23.9	-0.21	1.65																																																											
30	28.6	0																																																												
35	33	0																																																												
40	38	0	n≥2																																																											
C 	Wrench Flats 二面寬度追加加工。	HW-TSP004-12-80-9-10-9-10-7-10-Cd1 or Cd4-3(L5)-5(L6)-5(L7) Wrench Flats at the d1 or d4 Side. 在d1或d4端進行二面寬度追加加工。																																																												
E 	Coarse Tapping 攻牙孔追加加工。 <table border="1"> <thead> <tr> <th>d1(d4)</th> <th>M</th> </tr> </thead> <tbody> <tr><td>5/6</td><td>3</td></tr> <tr><td>7/8</td><td>3/4</td></tr> <tr><td>9/10</td><td>3/4/5</td></tr> <tr><td>11/12</td><td>3/4/5/6</td></tr> <tr><td>13-15</td><td>3/4/5/6/8</td></tr> <tr><td>16-24</td><td>3/4/5/6/8/10</td></tr> <tr><td>25-30</td><td>3/4/5/6/8/10/12/16</td></tr> <tr><td>31-39</td><td>3/4/5/6/8/10/12/16/20</td></tr> <tr><td>40</td><td>3/4/5/6/8/10/12/16/20/24/30</td></tr> </tbody> </table>	d1(d4)	M	5/6	3	7/8	3/4	9/10	3/4/5	11/12	3/4/5/6	13-15	3/4/5/6/8	16-24	3/4/5/6/8/10	25-30	3/4/5/6/8/10/12/16	31-39	3/4/5/6/8/10/12/16/20	40	3/4/5/6/8/10/12/16/20/24/30	HW-TSP004-12-80-9-10-9-10-7-10-Ed1 or Ed4-M3 Coarse Tapping at the d1 or d4 Side. 在d1或d4端進行攻牙孔追加加工。																																								
d1(d4)	M																																																													
5/6	3																																																													
7/8	3/4																																																													
9/10	3/4/5																																																													
11/12	3/4/5/6																																																													
13-15	3/4/5/6/8																																																													
16-24	3/4/5/6/8/10																																																													
25-30	3/4/5/6/8/10/12/16																																																													
31-39	3/4/5/6/8/10/12/16/20																																																													
40	3/4/5/6/8/10/12/16/20/24/30																																																													
F 	Square Chamfering 四角面追加加工。 <table border="1"> <thead> <tr> <th>d1 or d4</th> <th>r</th> </tr> </thead> <tbody> <tr><td>6-10</td><td>5-8</td></tr> <tr><td>11-14</td><td>8-10</td></tr> <tr><td>15-19</td><td>10-14</td></tr> <tr><td>20-25</td><td>14-20</td></tr> <tr><td>26-30</td><td>19-24</td></tr> <tr><td>31-35</td><td>22-28</td></tr> <tr><td>36-40</td><td>26-30</td></tr> </tbody> </table>	d1 or d4	r	6-10	5-8	11-14	8-10	15-19	10-14	20-25	14-20	26-30	19-24	31-35	22-28	36-40	26-30	HW-TSP004-12-80-9-10-9-10-7-10-Fd1 or Fd4-5(L5)-5(L6) Square Chamfering at the d1 or d4 Side. 在d1或d4端進行四角面追加加工。																																												
d1 or d4	r																																																													
6-10	5-8																																																													
11-14	8-10																																																													
15-19	10-14																																																													
20-25	14-20																																																													
26-30	19-24																																																													
31-35	22-28																																																													
36-40	26-30																																																													
G 	Threaded 外螺牙追加加工。 <table border="1"> <thead> <tr> <th>d1(d2)</th> <th>MxPitch</th> <th>d1(d2)</th> <th>MxPitch</th> </tr> </thead> <tbody> <tr><td>8</td><td>M8x1.0</td><td>20</td><td>M20x1.0</td></tr> <tr><td>10</td><td>M10x1.0</td><td>25</td><td>M25x1.5</td></tr> <tr><td>12</td><td>M12x1.0</td><td>30</td><td>M30x1.5</td></tr> <tr><td>14</td><td>M14x1.0</td><td>35</td><td>M35x1.5</td></tr> <tr><td>15</td><td>M15x1.0</td><td>40</td><td>M40x1.5</td></tr> <tr><td>17</td><td>M17x1.0</td><td></td><td></td></tr> </tbody> </table>	d1(d2)	MxPitch	d1(d2)	MxPitch	8	M8x1.0	20	M20x1.0	10	M10x1.0	25	M25x1.5	12	M12x1.0	30	M30x1.5	14	M14x1.0	35	M35x1.5	15	M15x1.0	40	M40x1.5	17	M17x1.0			HW-TSP004-12-80-9-10-9-10-7-10-Gd1 or Gd2-5(L5) Threaded at the d1 or d2 Side. 在d1或d2端進行外螺牙追加加工。																																
d1(d2)	MxPitch	d1(d2)	MxPitch																																																											
8	M8x1.0	20	M20x1.0																																																											
10	M10x1.0	25	M25x1.5																																																											
12	M12x1.0	30	M30x1.5																																																											
14	M14x1.0	35	M35x1.5																																																											
15	M15x1.0	40	M40x1.5																																																											
17	M17x1.0																																																													
H 	Keyway 鍵槽追加加工。 <table border="1"> <thead> <tr> <th rowspan="2">d1/d2 or d4</th> <th rowspan="2">b1</th> <th colspan="2">keyway size 軸槽的尺寸</th> </tr> <tr> <th>TOL.</th> <th>TOL.</th> </tr> </thead> <tbody> <tr><td>6/7</td><td>2</td><td>0.004</td><td>1.2</td></tr> <tr><td>8-10</td><td>3</td><td>-0.029</td><td>1.8</td></tr> <tr><td>11/12</td><td>4</td><td>0</td><td>2.5</td></tr> <tr><td>13-17</td><td>5</td><td>0</td><td>3.0</td></tr> <tr><td>18-22</td><td>6</td><td>-0.030</td><td>3.5</td></tr> <tr><td>23-30</td><td>8</td><td>0</td><td>4.0</td></tr> <tr><td>31-38</td><td>10</td><td>-0.036</td><td>5.0</td></tr> <tr><td>39/40</td><td>12</td><td>0</td><td>5.0</td></tr> </tbody> </table>	d1/d2 or d4	b1	keyway size 軸槽的尺寸		TOL.	TOL.	6/7	2	0.004	1.2	8-10	3	-0.029	1.8	11/12	4	0	2.5	13-17	5	0	3.0	18-22	6	-0.030	3.5	23-30	8	0	4.0	31-38	10	-0.036	5.0	39/40	12	0	5.0	HW-TSP004-12-80-9-10-9-10-7-10-Hd1/Hd2 or Hd4-5(L5)-3(L6) Keyway at the d1/d2 or d4 Side. 在d1/d2或d4端進行鍵槽追加加工。																						
d1/d2 or d4	b1			keyway size 軸槽的尺寸																																																										
		TOL.	TOL.																																																											
6/7	2	0.004	1.2																																																											
8-10	3	-0.029	1.8																																																											
11/12	4	0	2.5																																																											
13-17	5	0	3.0																																																											
18-22	6	-0.030	3.5																																																											
23-30	8	0	4.0																																																											
31-38	10	-0.036	5.0																																																											
39/40	12	0	5.0																																																											